

MVUSD District

Asphalt Replacement, Slurry Re-Stripe Project 2018

Overview of work required for project, drawings attached for each site.

******PLEASE PRICE EACH SITE SEPARATELY******

BID# 04052018-01

Monte Vista Elementary – (Approx. 113,029 sq. ft.) Slurry re-stripe all parking lots, bus loop, hardscape areas, playground, and access road. Provide quote for 10,000 linear feet of crack fill. Clean loose dirt and debris, apply two coats slurry with surface preparation and application to conform to manufacturers recommendations. Re-stripe to original configuration.

Murrieta Elementary – (Approx. 79,156 sq. ft.) Remove and replace existing asphaltic paving in kindergarten playground as indicated on site map. Slurry re-stripe all parking lots, hardscape areas, basketball courts and access road. Provide quote for 10,000 linear feet of crack fill. Clean loose dirt and debris, apply two coats slurry with surface preparation and application to conform to manufacturers recommendations. Re-stripe to original configuration.

Rail Ranch Elementary – (Approx. 97,992 sq. ft.) Slurry re-stripe two parking lots, hardscape areas, basketball courts and access road. Provide quote for 10,000 linear feet of crack fill. Clean loose dirt and debris, apply two coats slurry with surface preparation and application to conform to manufacturers recommendations. Re-stripe to original configuration.

MVUSD District

Asphalt Replacement, Slurry Re-Stripe Project 2018

Overview of work required for project, drawings attached for each site.

******PLEASE PRICE EACH SITE SEPARTELY******

BID# 04052018-01

Tovashal Elementary – (Approx. 134,029 sq. ft.) Slurry re-stripe all parking lots, hardscape areas, basketball courts and access road. Provide quote for 10,000 linear feet of crack fill. Clean loose dirt and debris, apply two coats slurry with surface preparation and application to conform to manufacturers recommendations. Re-stripe to original configuration.

Murrieta Mesa High School – Remove and replace existing basketball playground asphalt (Approx. 30,396 sq. ft.) replace with 4 inches of new asphalt. Re-stripe to original striping.

Vista Murrieta High School – Remove and replace existing asphaltic paving as indicated. (Refer to WLC Documents). Provide basketball court, and pickle ball court striping. **(Concrete walk replacement, basketball poles, pickle ball sleeves, chain link gate, and fencing are not part of this project).**

MURRIETA VALLEY UNIFIED SCHOOL DISTRICT



 Proposed Asphalt Slurry Locations:
 Total Est. square ft. = 113,029

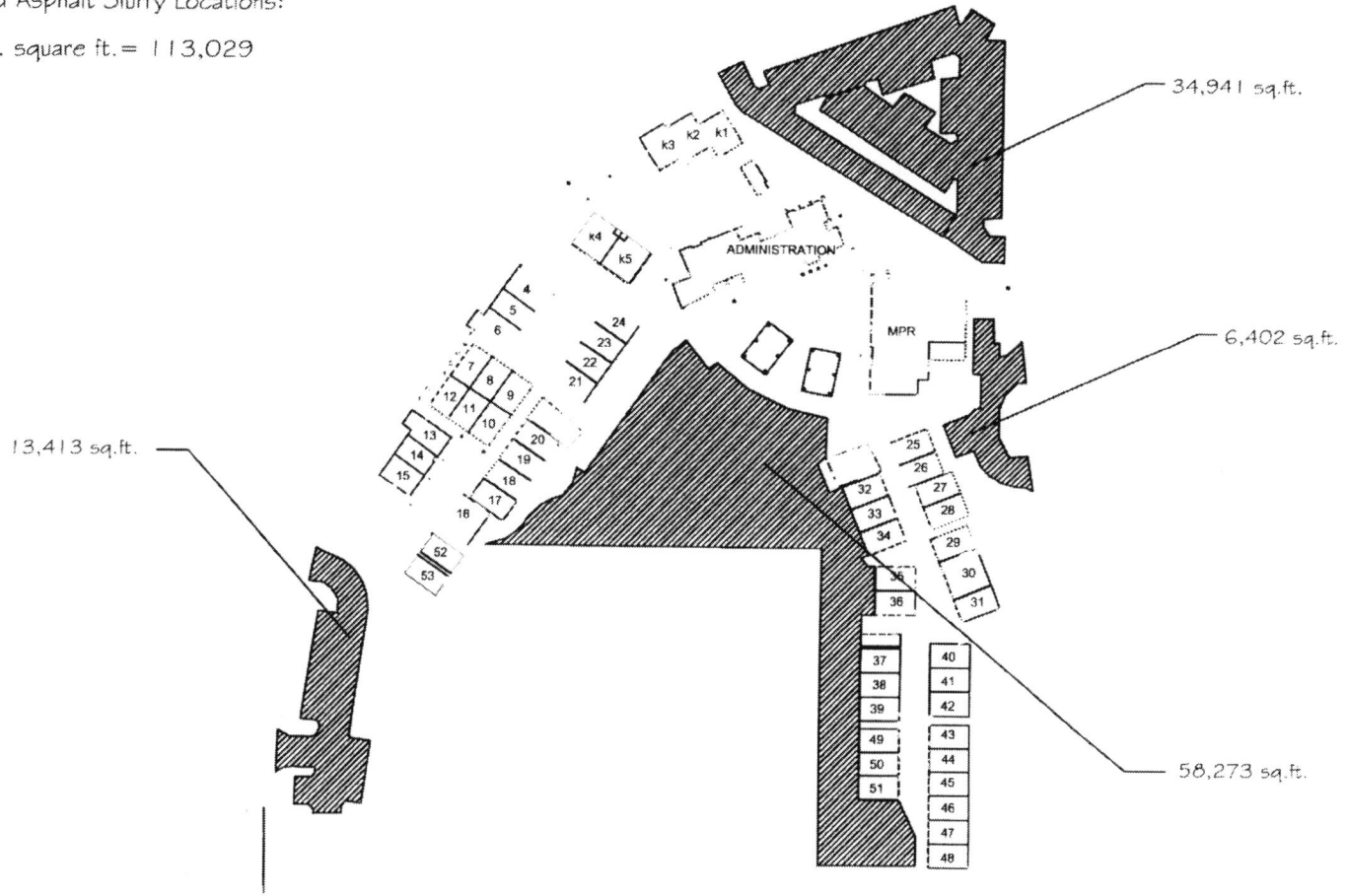

MURRIETA VALLEY UNIFIED SCHOOL DISTRICT
 CONSTRUCTION/PLANNING
 411870 McALBY COURT
 MURRIETA, CA 92562
 TEL:(909) 696-1600 FAX:(909) 696-1453

MONTE VISTA
Asphalt Slurry Project

DRAWN	R/WHITE
CHECKED	M/MLJRD
DATE	02-6-16
SCALE	AS NOTED
JOB NO.	PROJ.NO.

A-8

MURRIETA VALLEY UNIFIED SCHOOL DISTRICT

Proposed Asphalt Slurry Locations:

Total Est. square ft. = 79,156

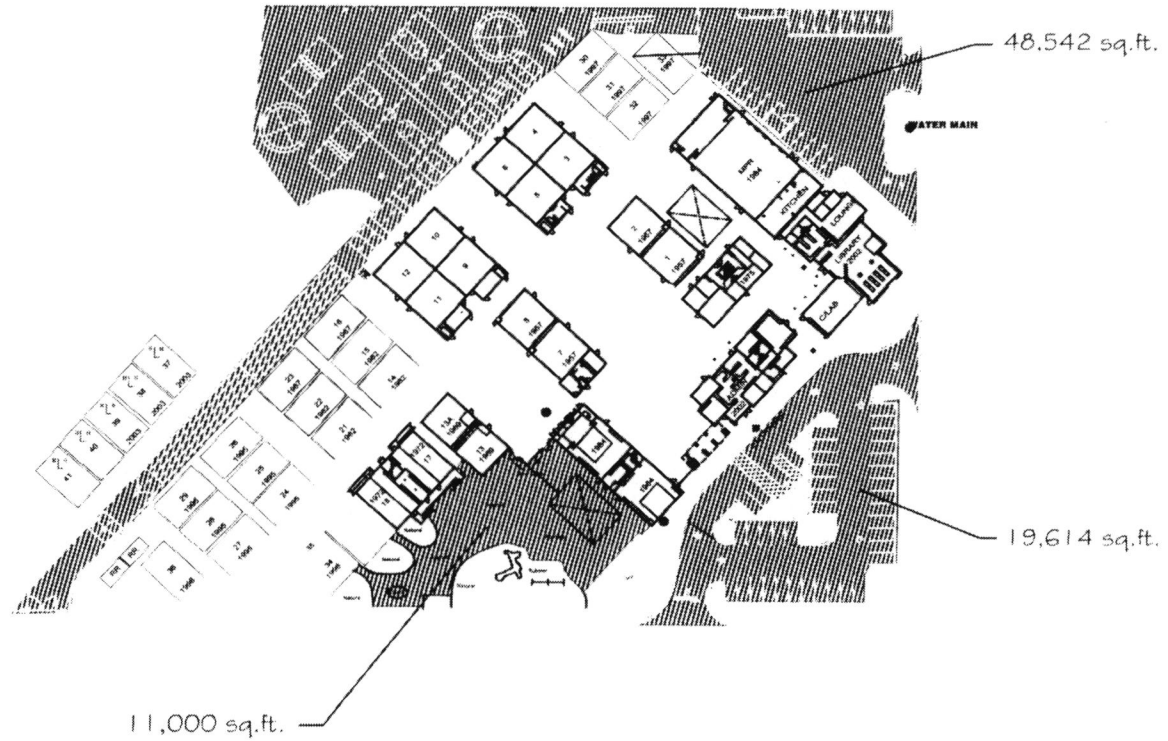

MURRIETA VALLEY UNIFIED SCHOOL DISTRICT
 CONSTRUCTION/PLANNING
 41870 McALBY COURT
 MURRIETA, CA 92562
 TEL: (909) 696-1600 FAX: (909) 696-1453

**Murrieta Elementary
 Asphalt Slurry Project**

DRAWN: RWHITE
 CHECKED: MHLURD
 DATE: 02-6-8
 SCALE: AS NOTED
 JOB NO.: PROJNO

A-9

MURRIETA VALLEY UNIFIED SCHOOL DISTRICT

Proposed Asphalt Slurry Locations:

Total Est. square ft. = 97,992

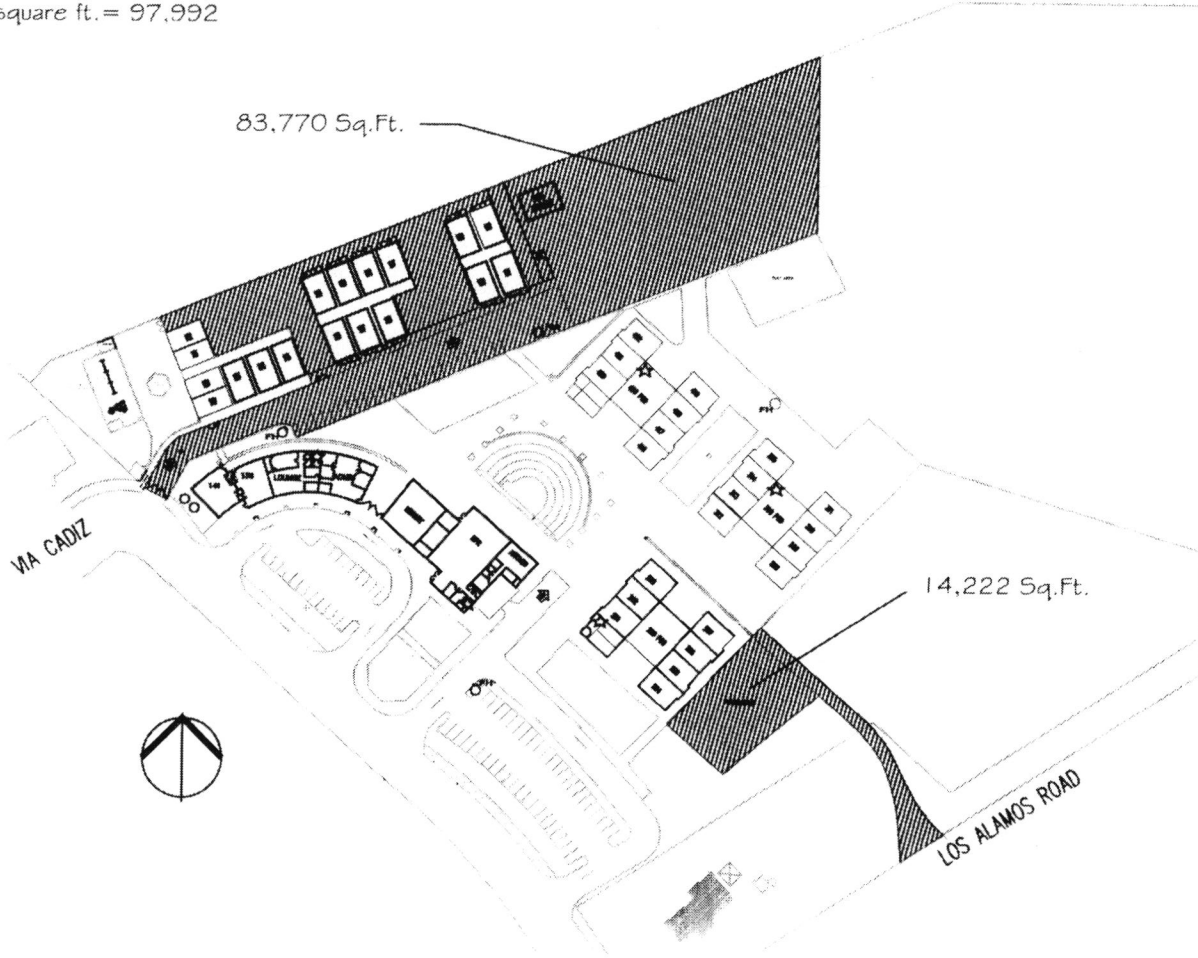

MURRIETA VALLEY UNIFIED SCHOOL DISTRICT
 CONSTRUCTION/PLANNING
 41870 MCALBY COURT
 MURRIETA, CA 92562
 TEL: (909) 696-1600 FAX: (909) 696-1453

**Rail Ranch Elem
 Asphalt Slurry Project**

DRAWN	RWHITE
CHECKED	MHURD
DATE	02-6-18
SCALE	AS NOTED
JOB NO.	PROJNO.

A-10

MURRIETA VALLEY UNIFIED SCHOOL DISTRICT

▨ Proposed Asphalt Slurry Locations:

Total Est. square ft. = 134,590

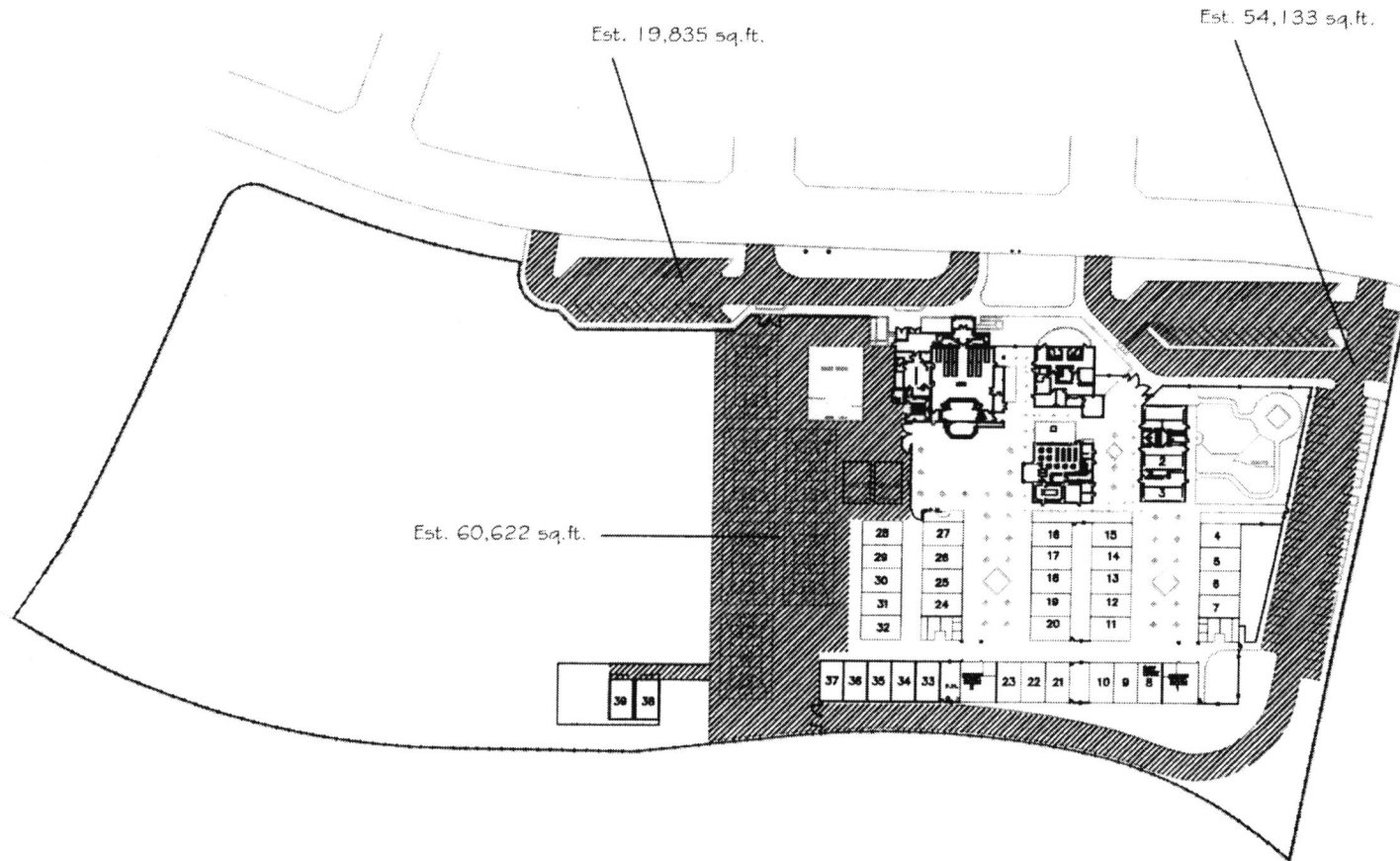

MURRIETA VALLEY UNIFIED SCHOOL DISTRICT
 CONSTRUCTION/PLANNING
 41870 McALBY COURT
 MURRIETA, CA 92562
 TEL: (909) 696-1600 FAX: (909) 696-1453

TOVASHAL
Asphalt Slurry Project

DRAWN: RWHITE
 CHECKED: MHURD
 DATE: 02-16-16
 SCALE: AS NOTED
 JOB NO.: PROJNO.

A-11

MURRIETA VALLEY UNIFIED SCHOOL DISTRICT

 Proposed Asphalt Slurry Locations:
 Total Est. square ft. = 30,396

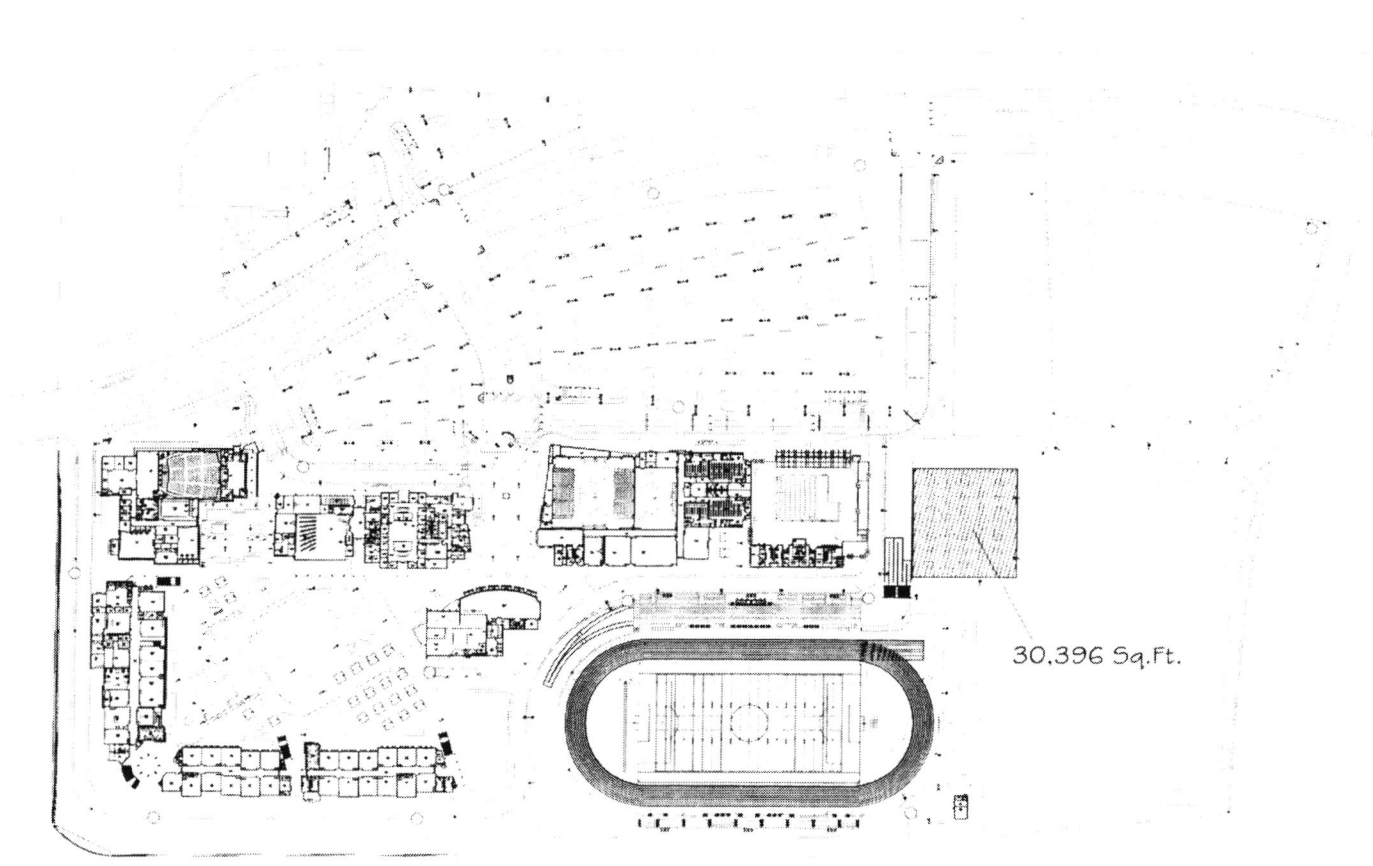

MURRIETA VALLEY UNIFIED SCHOOL DISTRICT
 CONSTRUCTION/PLANNING
 41870 McALBY COURT
 MURRIETA, CA 92562
 TEL:(909) 696-1600 FAX:(909) 696-1453

**Murrieta Mesa High
 Asphalt Slurry Project**

DRAWN: P.WHITE
 CHECKED: M.HURD
 DATE: 02/6/16
 SCALE: AS NOTED
 JOB NO.: PROJ.NO.

A-18

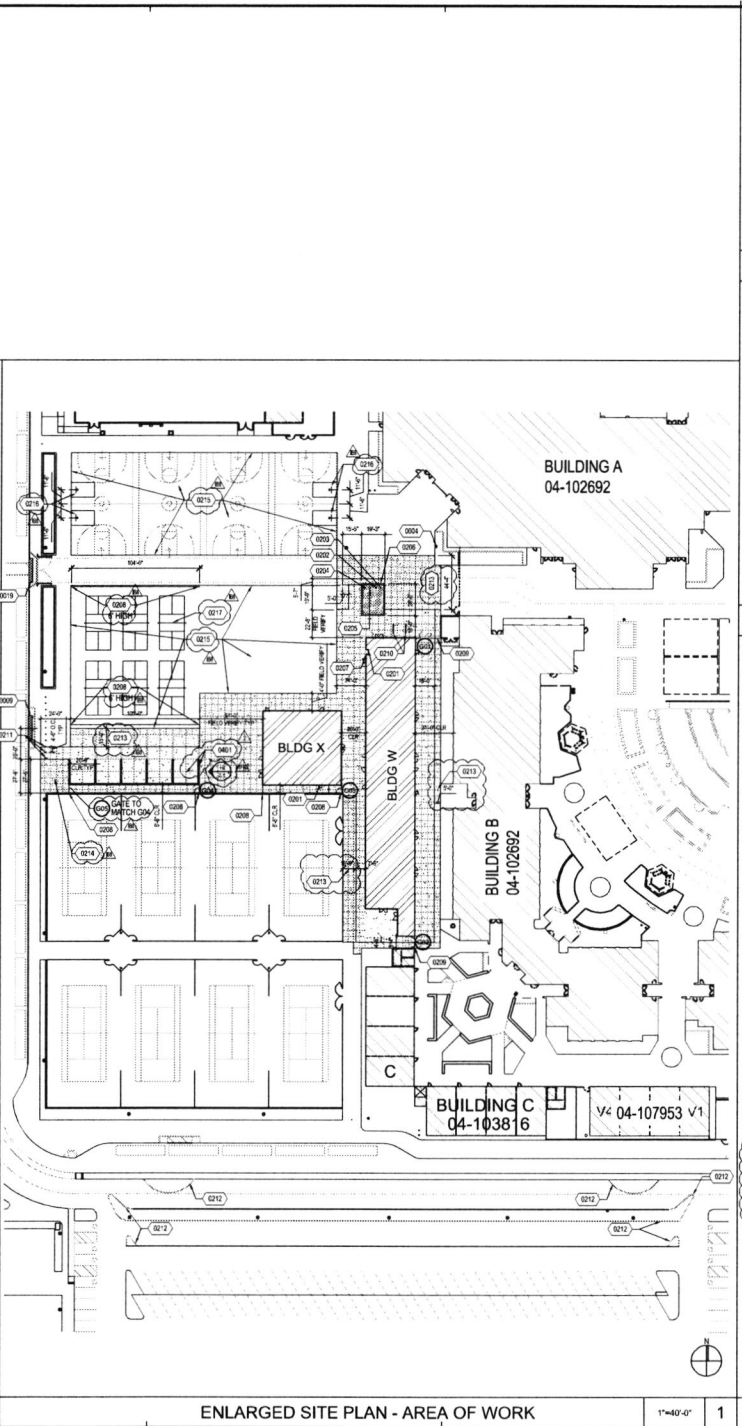
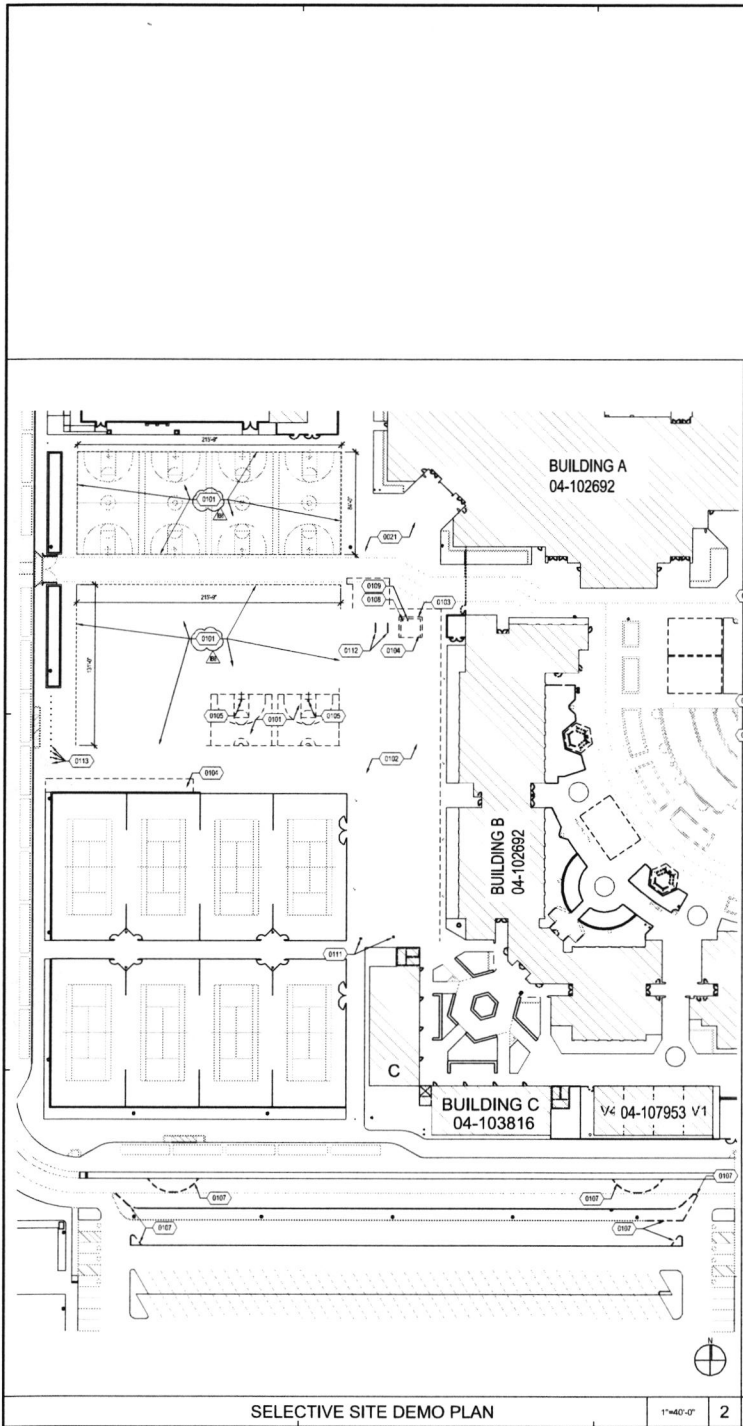

EXISTING BUILDING

NEW BUILDING

AREA OF NEW CONCRETE PAVING, REF CIVIL AND DET 22.1

AREA OF NEW PLANTER

GATE, REF GATE SCHEDULES DET 192.1 AND SPECIFICATIONS

- ### SITE LEGEND
- PROVIDE MEDIUM BROOM FINISH CONCRETE, WHERE IT OCCURS, USE NON-SLIP OR HEAVY BROOM FINISH WHERE SLOPE EXCEEDS 6%.
 - ALL MATERIALS AND DEBRIS FROM AREA SHALL BE TAKEN TO A PUBLIC, COUNTY OR CITY OPERATED DISPOSAL SITE.
 - ALL AREAS IN WHICH WORK IS DONE SHALL BE LEFT CLEAN AND IN GOOD REPAIR. ANY DAMAGE DONE TO EXISTING FENCE, PAVING, OR LANDSCAPE BY THE CONTRACTOR, SUBCONTRACTORS, OR THEIR EMPLOYEES SHALL BE REPAIRED TO THE SATISFACTION OF THE ARCHITECT AT NO COST TO THE OWNER.
 - PROVIDE NEW ROOM CONTROL, & EXIT STORAGE AT EACH DOOR OF EACH NEW BUILDING TO CONFORM WITH ADA & COR. TITLE 24.
 - CONNECT OR INSTALL NEW ELECTRICAL SERVICE FOR NEW BUILDINGS, REFER TO ELECTRICAL DRAWINGS.
 - REFER TO ARCHITECTURAL DRAWINGS FOR BUILDING CONSTRUCTION REQUIREMENTS.
 - GRATINGS LOCATED IN THE SURFACES OF ANY PEDESTRIAN WAY IN THE PATH OF TRAVEL SHALL HAVE GRID OPENINGS IN GRATINGS LIMITED TO 1/2" MAXIMUM IN SIZE IN THE DIRECTION OF TRAFFIC FLOW. IF SUCH CONDITION OCCURS, MANUFACTURERS CUT-SHEETS WILL BE PROVIDED FOR REVIEW.
 - GATES IN THE PATH OF TRAVEL MUST COMPLY WITH EXIT DOOR REQUIREMENTS OF CALIFORNIA BUILDING CODE (CBC) SECTION 11B-04.

- ### GENERAL NOTES
- 0006 EXISTING FIRE HYDRANT PER 04-102692
 - 0009 EXISTING LOADING ZONE W/ NEW TRUNCATED DOMES PER DET 52.1
 - 0019 EXISTING CURB RAMP WITH NEW TRUNCATED DOMES PER DET 52.1
 - 0020 EXISTING ASPHALT TO BE PROTECTED IN PLACE
 - 0021 EXISTING CONCRETE TO BE PROTECTED IN PLACE
 - 0101 EXISTING ASPHALT TO BE DEMOLISHED
 - 0102 EXISTING CONCRETE TO BE DEMOLISHED
 - 0103 EXISTING CONCRETE PLANTER WALL TO BE DEMOLISHED
 - 0104 EXISTING PLANTER TO BE DEMOLISHED, CAP OFF OR REROUTE/REPAIR EXISTING IRRIGATION WHERE NECESSARY
 - 0105 EXISTING BASKETBALL HOOP AND BACKBOARD TO BE REMOVED
 - 0106 EXISTING BASKETBALL POLE TO BE PROTECTED IN PLACE
 - 0107 EXISTING FIRE LANE CURB TO BE REMOVED
 - 0108 EXISTING POST INDICATOR VALVE TO BE RELOCATED
 - 0109 EXISTING FIRE DEPARTMENT CONNECTION TO BE RELOCATED
 - 0110 NOT USED
 - 0111 EXISTING CATCH BASIN TO BE DEMOLISHED, REF CIVIL PLANS
 - 0112 EXISTING BIKE RACKS TO BE RELOCATED
 - 0113 EXISTING BOLLARD TO BE DEMOLISHED
 - 0201 FIRE RISER LOCATION, REF FIRE SPRINKLER DRAWINGS
 - 0202 RELOCATED POST INDICATOR VALVE (PIV)
 - 0203 RELOCATED FIRE DEPARTMENT CONNECTION (FDC)
 - 0204 NEW POST INDICATOR VALVE (PIV)
 - 0205 NEW FIRE DEPARTMENT CONNECTION (FDC)
 - 0206 SEAT WALL PLANTER, REF DET 72.1
 - 0207 ACCESSIBLE DRINKING FOUNTAIN, REF PLUMBING DWGS & DET 229.4
 - 0208 CHAIN LINK FENCE, REF DET 172.1
 - 0209 TUBE STEEL FENCE, REF DET 92.1
 - 0210 RELOCATED BIKE RACKS
 - 0211 NEW BOLLARD TO MATCH EXISTING, REF DET 62.1
 - 0212 NEW FIRE LANE STRIP TO MATCH EXISTING OVER RESURFACED ASPHALT
 - 0213 NEW CONCRETE PAVING AT NORTH END OF HANDBALL COURTS
 - 0214 NEW CONCRETE PAVING AT PREVIOUS PLANTER LOCATION
 - 0215 NEW AC PAVING, REMOVE EXISTING AC PAVING
 - 0216 RELOCATED BASKETBALL POLE, HOOP AND BACKBOARD
 - 0217 (R) NEW PICKLE BALL COURTS, POLES AND NETS
 - 0301 1'-2" THICK X 26'-0" H CONC BALL WALL, REF S&T

ARCHITECTS

WIC

CLIENT FOCUSED · PASSION DRIVEN

SOUTHERN CALIFORNIA
8163 ROCHESTER AVENUE, SUITE 100
RANCHO CUCAMONGA
CALIFORNIA 91730-0729
TEL: 909-987-0909
www.wicarchitects.com

Murrieta Valley
United School District

CTE CLASSROOM ADDITION
VISTA MURRIETA HIGH SCHOOL
28251 CLINTON KEITH ROAD
MURRIETA, CA 92563

MURRIETA VALLEY UNIFIED SCHOOL DISTRICT

PTN 75200-83

CONSULTANT

APPROVED ARCHITECT
STATE OF CALIFORNIA

DATE: 04/25/2017
SCALE: AS NOTED
PROJECT NUMBER: 1615400

ENLARGED SITE PLAN AND DEMO PLAN

DRAWING NUMBER: A1.2